

ANNOTATIONS

- 1 Existing Changing Rooms.
- 2 Existing Car Parking.
- 3 Existing Flood Defence Bank.
- 4 Existing Vehicular Access Route over Flood Defence Bank.
- 5 Existing Cricket Pitch.
- 6 Existing Rugby Pitch. Approx o/a Size 126x75m.
- 7 Existing Rugby Pitch. Approx Playing Area 110x64m.
- 8 Existing Playing Field.
- 9 Railway Line.
- 10 Skate Park.
- 11 Millers Crossing.
- 12 Existing Exeter College Sports Hub & All Weather Football Pitch.

- Site Boundary
- Other Land in Ownership of Applicant.

Refer to Advanced Arboriculture Ltd. Tree Constraints Appraisal for details of Identified trees and tree groups in proximity of proposed development.

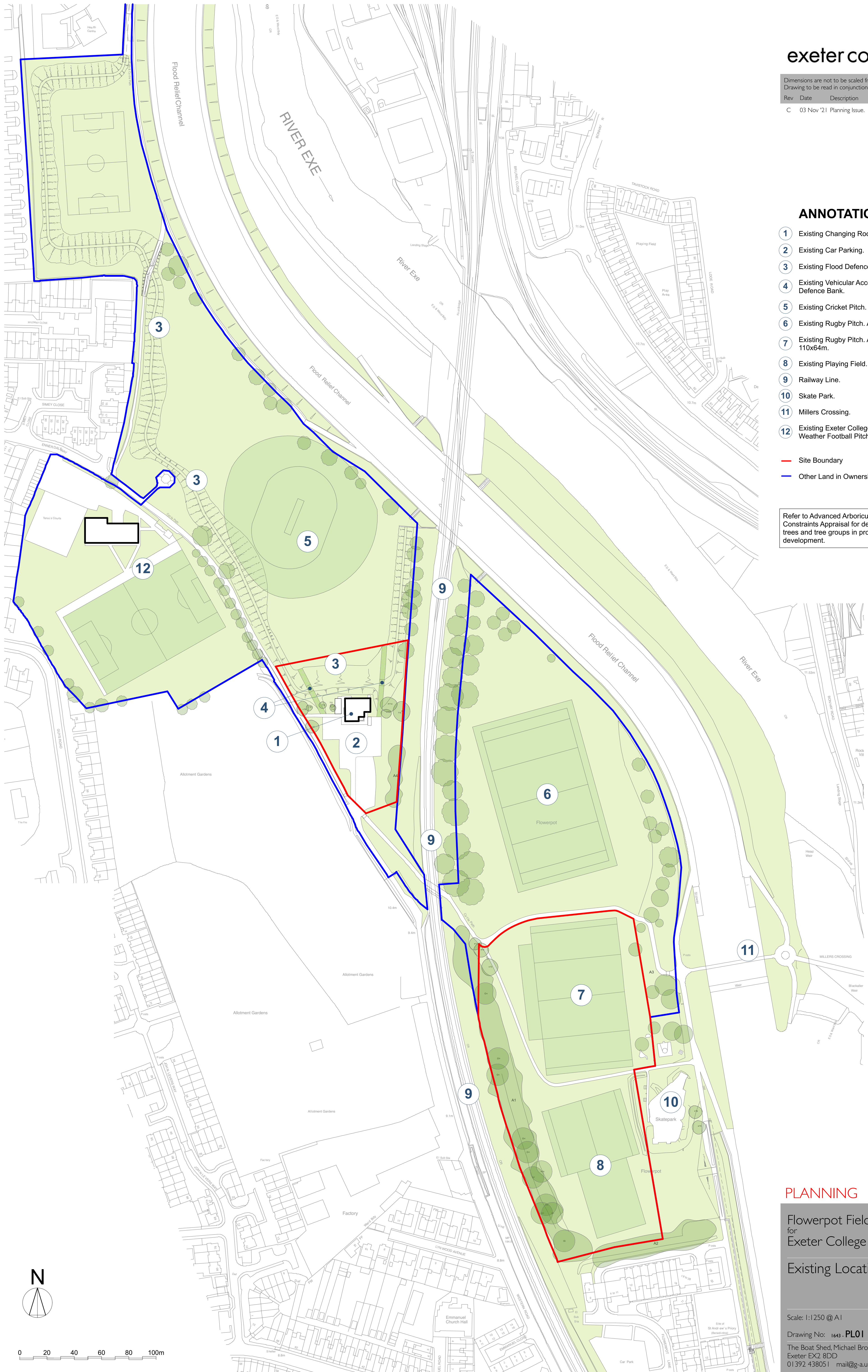

PLANNING

Flowerpot Fields Pavilion
for
Exeter College
Existing Location Plan

Scale: 1:1250 @ A1
Drawing No: 1643 - PL01 Rev C
The Boat Shed, Michael Browning Way
Exeter EX2 8DD
01392 438051 mail@g-a.uk.com